

TECHNICAL MANUAL

ORGANIZATIONAL, DIRECT SUPPORT, AND GENERAL SUPPORT  
MAINTENANCE REPAIR PARTS AND SPECIAL TOOLS LIST  
FOR  
MAINTENANCE KITS, ELECTRONIC EQUIPMENT  
MK-1978A/VRC (NSN 6625-01-078-5893)

HEADQUARTERS, DEPARTMENT OF THE ARMY

4 APRIL 1985



**ORGANIZATIONAL, DIRECT SUPPORT, AND GENERAL SUPPORT  
MAINTENANCE REPAIR PARTS AND SPECIAL TOOLS LIST  
FOR  
MAINTENANCE KITS, ELECTRONIC EQUIPMENT  
MK-1978A/VRC (NSN 6625-01-078-5893)**

Current as of 21 January 1985

**REPORTING ERRORS AND RECOMMENDING IMPROVEMENTS**

You can help improve this manual. If you find any mistakes or if you know of a way to improve the procedures, please let us know. Mail your letter, DA Form 2028 (Recommended Changes to Publications and Blank Forms), or DA Form 2028-2 located in back of this manual direct to: Commander, US Army Communications- Electronics Command and Fort Monmouth, ATTN: AMSEL-ME-MP, Fort Monmouth, NJ 07703-5007. In either case, a reply will be furnished direct to you.

**Table of Contents**

	<b>Page</b>	<b>Ills Figure</b>
SECTION I. Introduction .....	1	
II. Repair Parts List .....	II-1	
GROUP 00 Maintenance Kit, Electronics Equipment MK-1978A/VRC .....	II-1	1
01 Bag, Cotton Duck (No parts authorized)		
02 Maintenance Kit Assembly .....	II-1	2
0201 Cover Assembly .....	II-2	3
0202 Case Assembly .....	II-2	4
03 Panel Assembly .....	II-2	5
0301 Cable Assembly .....	II-3	6
Cable Assembly .....	II-3	7
Cable Assembly .....	II-3	8
Cable Assembly .....	II-3	9
Cable Assembly .....	II-3	10
Cable Assembly .....	II-4	11
0302 Cable, Receiver-Transmitter .....	II-4	12
0303 Cable Assembly, Heat Exchanger Extender.....	II-4	13
SECTION III Special Tools List (Not applicable)		
IV. National Stock Number and Part Number Index .....	I-1	

**SECTION I.  
INTRODUCTION**

**1. Scope**

This manual lists and authorizes spares and repair parts; special tools; special test, measurement, and diagnostic equipment (TMDE); and other special support equipment required for performance of organizational, direct support, and general support maintenance of the MK- 1978A/VRC. It authorizes the requisitioning, issue, and disposition of spares, repair parts and special tools as indicated by the source, maintenance and recoverability (SMR) codes.

**2. General**

This Repair Parts and Special Tools List is divided into the following sections:

a. *Section II. Repair Parts List.* A list of spares and repair parts authorized by this RPSTL for use in the performance of maintenance. The list also includes parts which must be removed for replacement of the authorized parts. Parts lists are composed of functional groups in ascending numeric sequence, with the parts in each group listed in ascending item number sequence. Figure numbers are listed directly beneath the group header.

b. *Section III. Special Tools List.* Not applicable.

c. *Section IV. National Stock Number and Part Number Index.* A list, in National item identification number (NMIN) sequence, of all National stock numbered items appearing in the listing, followed by a list in alphameric sequence of all part numbers appearing in the listings. National stock numbers and part numbers are cross-referenced to each illustration figure and item number appearance.

**3. Explanation of Columns (Section II and Section III)**

a. *Item No. (Column (1)).* Indicates the number used to identify items called out in the illustration.

b. *SMR Code (Column (2)).* The source, maintenance, and recoverability (SMR) code is a five-position code containing supply/requisitioning information, maintenance category authorization criteria, and disposition instruction, as shown in the following breakout:

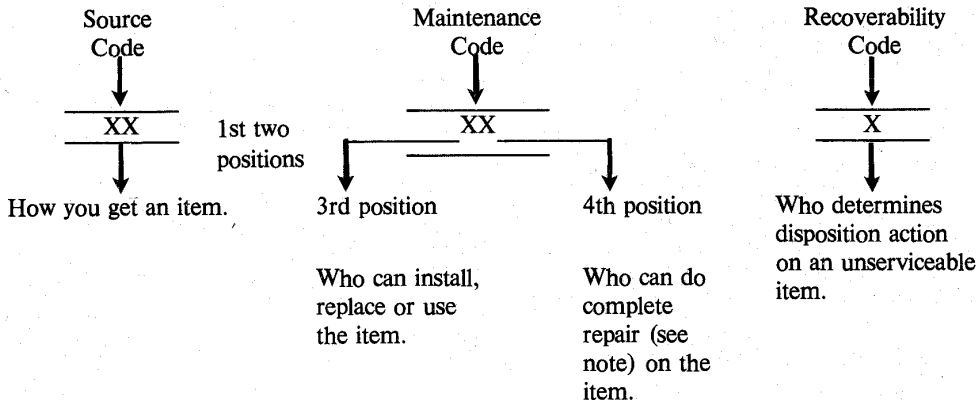

**NOTE**

Complete repair: Maintenance capacity, capability, and authority to perform all corrective maintenance tasks of the "Repair" function in a use/user environment in order to restore serviceability to a failed item.

(1) *Source code.* The source code tells you how to get an item needed for maintenance, repair, or overhaul of an end item/equipment. Explanations of source codes follows:

Code

- PA
- PB
- PC
- PD
- PE
- PF
- PG

Explanation

Stocked items; use the applicable NSN to request/requisition items with these source codes. They are authorized to the category indicated by the code entered in the third position of the SMR code.

**NOTE**

Items coded PC are subject to deterioration.

*Code*

KD  
KF  
KB

MO—Made at org/AVUM category  
MF—Made at DS/AVUM category  
MH—Made at GS category  
ML—Made at Specialized Repair Activity (SRA)  
MD—Made at Depot

AO—Assembled by org/AVUM category  
AF—Assembled by DS/AVIM category  
AH—Assembled by GS category  
AL—Assembled by SRA  
AD—Assembled by Depot

*Explanation*

Items with these codes are not to be requested/requisitioned individually. They are part of a kit which is authorized to the maintenance category indicated in the third position of the SMR code. The complete kit must be requisitioned and applied.

Items with these codes are not to be requested/requisitioned individually. They must be made from bulk material which is identified by the part number in the description and usable on code (UOC) column and listed in the Bulk Material group of the repair parts list. If the item is authorized to you by the third position code of the SMR code, but the source code indicates it is made at a higher category, order the item from the higher category of maintenance.

Items with these codes are not to be requested/requisitioned individually. The parts that make up the assembled item must be requisitioned or fabricated and assembled at the category of maintenance indicated by the source code. If the disposition code of the SMR code authorizes you to replace the item, but the source code indicates the item is assembled at a higher category, order the item from the higher category of maintenance.

*Code*

XA—Do not requisition an "XA" coded item. Order its next higher assembly.  
XB—If an "XB" item is not available from salvage, order it using the FSCM and part number given.  
XC—Installation drawing, diagram, instruction sheet, field service drawing, that is identified by manufacturers part number.  
XD—Item is not stocked. Order an "XD" coded item through normal supply channels using the FSCM and part number given, if no NSN is available.

*Explanation*

**NOTE**

Cannibalization or controlled exchange, when authorized, may be used as a source of supply for items with the above source codes, except for those source coded "XA" or those aircraft support items restricted by requirements of AR 750-1.

(2) *Maintenance code.* Maintenance codes tell you the category of maintenance authorized to USE and REPAIR support items. The maintenance codes are entered in the third and fourth positions of the SMR code as follows:

(a) The maintenance code entered in the third position tells you the lowest maintenance category authorized to remove, replace, and use an item. The maintenance code entered in the third position will indicate authorization to one of the following categories of maintenance.

*Code*

*Application/Explanation*

C—Crew or operator maintenance done within organizational or aviation maintenance.  
O—Organizational or aviation unit category can remove, replace, and use the item.  
F—Direct support or aviation intermediate category can remove, replace, and use the item.  
H—General support category can remove, replace, and use the item.  
L—Specialized repair activity can remove, replace, and use the item.  
D—Depot category can remove, replace, and use the item.

(b) The maintenance code entered in the fourth position tells whether or not the item is to be repaired and identifies the lowest maintenance category with the capability to do complete repair (i.e., perform all authorized repair functions). This position will contain one of the following maintenance codes.

**NOTE**

Some limited repair may be done on the item at a lower category of maintenance, if authorized by the Maintenance Allocation Chart (MAC) and SMR codes.

*Code*

*Application/Explanation*

O—Organizational or aviation unit is the lowest category that can do complete repair of the item.  
F—Direct support or aviation intermediate is the lowest category that can do complete repair of the item.  
H—General support is the lowest category that can do complete repair of the item.  
L—Specialized repair activity (designate the specialized repair activity) is the lowest category that can do complete repair of the item.

<i>Code</i>	<i>Application/Explanation</i>
-------------	--------------------------------

D—Depot is the lowest category that can do complete repair of the item.

Z—Nonreparable. No repair is authorized.

B—No repair is authorized. (No parts or special tools are authorized for the maintenance of a "B" coded item). However, the item may be reconditioned by adjusting, lubricating, etc., at the user category.

(3) *Recoverability code.* Recoverability codes are assigned to items to indicate the disposition action on unserviceable items. The recoverability code is entered in the fifth position of the SMR Code as follows:

*Recoverability*

*codes*

*Application/Explanation*

Z—Nonreparable item. When unserviceable, condemn and dispose of the item at the category of maintenance shown in the third position of SMR Code.

O—Reparable item. When uneconomically reparable, condemn and dispose of the item at organizational or aviation unit category.

F—Reparable item. When uneconomically reparable, condemn and dispose of the item at direct support or aviation intermediate category.

H—Reparable item. When uneconomically reparable, condemn and dispose of the item at general support category.

D—Reparable item. When beyond lower category repair capability, return to depot. Condemnation and disposal of item not authorized below depot category.

L—Reparable item. Condemnation and disposal not authorized below specialized repair activity (SRA).

A—Item requires special handling or condemnation procedures because of specific reasons (e.g., precious metal content, high dollar value, critical material, or hazardous material). Refer to appropriate manuals/directives for specific instructions.

c. *FSCM (Column (3)).* The Federal Supply Code for Manufacturer (FSCM) is a 5-digit numeric code which is used to identify the manufacturer, distributor, or Government agency, etc., that supplies the item.

d. *Part Number (Column (4)).* Indicates the primary number used by the manufacturer (individual, company, firm, corporation, or Government activity), which controls the design and characteristics of the item by means of its engineering drawings, specifications, standards, and inspection requirements to identify an item or range of items.

**NOTE**

When you use a NSN to requisition an item, the item you receive may have a different part number from the part ordered.

e. *Description and Usable on Code (UOC) (Column (5)).* This column includes the following information.

(1) The Federal item name and, when required, a minimum description to identify the item.

(2) The statement "END OF FIGURE" appears just below the last item description in Column (5) for a given figure in both section II and section III.

f. *Qty (Column (6)).* Indicates the quantity of the item used in the breakout shown on the illustration figure, which is prepared for a functional group, subfunctional group, or an assembly. A "V" appearing in this column in lieu of a quantity indicates that the quantity is variable and the quantity may vary from application to application.

**4. Explanation of Columns (Section IV)**

a. *National Stock Number (NSN) Index.*

(1) *Stock number column.* This column lists the NSN by National item identification number (NIIN) sequence. The NIIN consists of the last nine digits of the NSN. When using this column to locate an item, ignore the first four digits of the NSN. When requisitioning items use the complete NSN (13 digits).

(2) *Fig. column.* This column lists the number of the figure where the item is identified/located. The illustrations are in numerical sequence in sections II and III.

(3) *Item column.* The item number identifies the item associated with the figure listed in the adjacent Fig. column. This item is also identified by the NSN listed on the same line.

b. *Part Number Index.* Part numbers in this index are listed by part number in ascending alphameric sequence.

(1) *FSCM column.* This column lists the Federal supply code for manufacturer (FSCM).

(2) *Part number column.* This column indicates the part number assigned to the item.

(3) *Stock number column.* This column lists the National stock number for the associated part number and manufacturer identified in the part number and FSCM columns to the left.

(4) *Fig. column.* This column lists the number of the figure where the item is identified/located in sections II and III.

(5) *Item column.* The item number is that number assigned to the item as it appears in the figure referenced in the adjacent figure number column.

## 5. Special Information

*a. Associated Publications.* The publication listed below pertains to the MK-1978A/VRC and its components: TM 11-6625-2971-14, Maintenance Kits, Electronic Equipment MK-1978/VRC and MK-1978A/VRC.

*b. National Stock Numbers.* National stock numbers (NSN's) that are missing from P source coded items have been applied for and will be added to this TM by future change/revision when they are entered in the Army Master Data File (AMDF). Until the NSN's are established and published, submit exception requisitions to: Commander, US Army Communications-Electronics Command and Fort Monmouth, ATTN; AMSEL-MM, Fort Monmouth, NJ 07703-5006 for the part required to support your equipment.

## 6. How to Locate Repair Parts

*a. When National stock number or part number is not known.*

(1) *First.* Using the table of contents, determine the assembly group or subassembly group to which the item belongs. This is necessary since figures are prepared for assembly groups and subassembly groups, and listings are divided into the same groups.

(2) *Second.* Find the figure covering the assembly group or subassembly group to which the item belongs.

(3) *Third.* Identify the item on the figure and note the item number.

(4) *Fourth.* Refer to the Repair Parts List for the figure to find the part number for the item number noted on the figure.

(5) *Fifth.* Refer to the Part Number Index to find the NSN, if assigned.

*b. When National stock number or part number is known.*

(1) *First.* Using the index of National stock numbers and part numbers, find the pertinent National stock number or part number. The NSN index is in National item identification number (NIIN) sequence (para 4a(1)). The part numbers in the part number index are listed in ascending alphameric sequence (para 4b). Both indexes cross-reference you to the illustration figure and item number of the item you are looking for.

(2) *Second.* After finding the figure and item number, verify that the item is the one you're looking for, then locate the item number in the repair parts list for the figure.

## 7. Abbreviations

Not applicable.

SECTION II.

TM 11-6625-2971-24P

(1) ITEM NO	(2) SMR CODE	(3) FSCM	(4) PART NUMBER	(5) DESCRIPTION AND USABLE ON CODES(UOC)	(6) QTY
GROUP 00 MAINTENANCE KITS, ELECTRONIC EQUIPMENT MK-1978A/VRC					
FIGURE 1					
a	e				
1	PAFZZ	80063	A3002186	BAG,TEXTILE .....	1
2	XBFFF	80063	A3002187	BOX, ASSEMBLY ( FOR PARTS BREAKDOWN SEE FIGURE 2) .....	1
4	PAFFF	8005863	A3000711	CABLE ASSEMBLY, POWE .....	1
5	PAFZZ	80063	A3000791	CABLE ASSEMBLY, RAD ( FOR PARTS.....	2
6	PAFZZ	80063	SC-D-68284-4-1	BREAKDOWN SEE FIGURE 12 ) .....	
7	PAFZZ	80058	CG1127BU2-6	CABLE ASSEMBLY, RAD.....	1
8	PAFZZ	80063	A3000713	CABLE ASSEMBLY, RAD.....	4
9	PAFFF	80063	A3002176	CABLE ASSEMBLY, SPEC (FOR PARTS .....	2
10	PAFZZ	80063	A3000796	BREAKDOWN SEE FIGURE 13 ) .....	1
11	PAFZZ	80063	A3000793	STAND .....	1
12	PAFZZ	80063	A3000785	CABLE ASSEMBLY, SPEC .....	2
13	PAFZZ	98291	51-074-6800	CABLE ASSEMBLY, SPEC .....	2
14	PAFZZ	98291	51-085-0000	ADPTER, CONNECTOR .....	1
15	PAFZZ	81349	MM55339/17-00274	ADAPTER, CONNECTOR .....	1
16	PAFZZ	80634	WC440TYPETC1	CLIP, ELECTRICAL .....	1
17	PAFZZ	71279	3226-3	CORE .....	15
18	PAFZZ	71279	5153-226-04-21-0	CORE .....	10
19	PAFZZ	80063	SM-C-413781	CORE, ADJUSTABLE TUN .....	10
20	XBFCZ	80063	A3002195-1	STRIP .....	10
21	PAFZZ	80063	MS-B-481760	PLASTIC STRIP.....	25
22	XBFZZ	80063	A3000715	COVER, ALIGNMENT .....	1
23	XBFZZ	80063	A3000716	COVER, ALIGNMENT .....	1
24	XBFZZ	80063	A3000719	COVER, ALIGNMENT .....	1
25	PEFZZ	96508	99-23	BIT SCREWDRIVER .....	1
26	PEFZZ	96508	99-25	BIT SCREWDRIVER .....	1
27	PEFZZ	96508	99-964	Bit, SCREWDRIVER .....	1
28	PEFZZ	05574	000407-0003	ALIGNMENT TOOL, CONT .....	1
29	PEFZZ	80063	A3000717	ALIGNMENT TOOL, ELECT.....	1
30	PEFZZ	73899	5284	ALIGNMENT TOOL, ELECT.....	1
31	PEFZZ	05574	000407-0004	REMOVAL TOOL, CONNec .....	1
32	PEFZZ	96508	99-4	T-HANDLE, NUTDRIVER .....	1

GROUP 02 MAINTENACE KIT ASSEMBLY

FIGURE 2

1	XBFFF	80063	A3002171	COVER ASSEMBLY ( FOR PARTS .....	1
2	PAFF	8063	A302170	BREAKDOWN SEE FIGURE 3 ) .....	1
				BOX ASSEMBLY ( FOR PARTS BREAKDOWN SEE FIGURE 4 ) .....	1

## SECTION II

TM 11-6625-2971-24P

(1) ITEM NO	(2) SMR CODE	(3) FSCM	(4) PART NUMBER	(5) DESCRIPTION AND USABLE ON CODES(UOC)	(6) QTY
3	XAFFF	80063	A3002174	PANEL, ASSEMBLY ( FOR PARTS .....	1
				BREAKDOWN SEE FIGURE 5 1 .....	
4	PAFZZ	96906	MS27183-6	WASHER, FLAT .....	12
5	PAFZZ	96906	MS35206-230	SCREW, MACHINE .....	12
GROUP 0201 COVER ASSEMBLY					
FIGURE 3					
1	PAFZZ	80063	A3002171-1	COVER .....	1
2	XBFZZ	80063	A3002169	HANDLE .....	1
3	PAFZZ	96906	MS18015-3	STRIKE, CATCH.....	4
4	PAFZZ	96906	MS20470-AD4-6	RIVET, SOLID.....	8
5	PAFZZ	59730	TC105	BASE, MOUNTING .....	2
GROUP 0202 CASE ASSEMBLY					
FIGURE 4					
1	XBFZZ	80063	A3002170-1	BOX .....	1
2	PAFZZ	99256	LK632-2	NUT, SELF-LOCKING, CL.....	8
3	XBFZZ	80063	A3000721	NAME PLATE .....	1
4	PAFZZ	96906	MS20470-AD4-6	RIVET, SOLID.....	8
5	PAFZZ	96906	MS18015-2	LATCH .....	4
GROUP 03 PANEL ASSEMBLY					
FIGURE 5					
1	PAFZZ	96906	MS35058-24	SWITCH, TOGGLE .....	3
2	PAFZZ	96906	MS35059-23	SWITCH, TOGGLE .....	2
3	PAFZZ	81349	M55339/13-00492	ADAPTER, CONNECTOR .....	4
4	PAFZZ	81349	M39024/10-01	JACK, TIP .....	11
5	PAFZZ	96906	MS24523-21	SWITCH, TOGGLE .....	1
6	PAFZZ	96906	MS35058-23	SWITCH, TOGGLE .....	1
7	XAFZZ	80063	A3002167	PANEL, FRONT .....	1
8	PAFZZ	81349	M8805/96-001	SWITCH, PUSH.....	1
9	PAFZZ	96906	MS25237-327	LAMP INCANDESCENT .....	13
10	PAOZZ	72619	177-8430-0933-50	LIGHT, INDICATOR.....	13
		3			
11	XBFZZ	80063	A3000718	TERMINAL LUG .....	2
12	PAFZZ	81349	RCR07GI22JS	RESISTOR, FIXED, COMP .....	100
13	PAFZZ	83330	1496	TERMINAL, LUG .....	8
14	PAFZZ	81349	RCR07GIS1JS	RESISTOR, FIXED, COMP .....	2
15	XBFZZ	80063	A3002798	CABLE, ASSEMBLY, RADI.....	1
16	PAFZZ	98291	51-074-6800	ADAPTER, CONNECTOR .....	3
17	PAFZZ	80063	SM-D-414364-8	CABLE ASSEMBLY, RADI.....	1
18	PPFZZ	80063	A3000800	CABLE ASSEMBLY SET,.....	1
19	PAFZZ	96906	MS27183-13	WASHER, FLAT .....	1



## SECTION II

TM 11-6625-2971-24P

(1) ITEM NO	(2) SMR CODE	(31) PART FSCM	(4) NUMBER	(5) DESCRIPTION AND USABLE ON CODES(UOC)	(6) QTY
20	XBFZZ	80063	A3000706	BRACKET .....	1
21	PAFZZ	80063	SM-D-414384	SWITCH, RADIO FREQUE .....	1
22	XBFZZ	80063	A3002188	CABLE ASSEMBLY .....	1
23	PAFZZ	96906	MS25036-102	TERMINAL, LUG.....	15
24	XBFZZ	80063	A3002178	CABLE ASSEMBLY .....	1
25	XBFZZ	80063	A3002180	CABLE ASSEMBLY .....	1
26	XBFZZ	80063	A300217T	CABLE ASSEMBLY .....	1
27	XBFZZ	80063	A3002173	PLAT ASSEMBLY .....	1
28	PAFZZ	80063	A3002179	CABLE ASSEMBLY, SPECC.....	1
29	PAFZZ	96906	MS3367-4-9	STRAP, TIEDOWN, ELECT .....	8
GROUP 0301 CABLE ASSEMBLY					
FIGURE 6					
1	PAFZZ	81349	MW20(MM)A00	CONNECTOR, RECEPTACL .....	10
2	PAFZZ	96906	MS25036-106	TERMINAL, LUG .....	1
GROUP 0301 CABLE ASSEMBLY					
FIGURE 7					
1	PAFZZ	81349	U-288/U	CONNECTOR, RCPT, ELEC.....	1
2	XBFZZ	80063	SC-C-681320	BAND, IDENTIFICATION .....	1
GROUP 0301 CABLE ASSEMBLY					
FIGURE 8					
1	PAFZZ	80063	SM-D-414991	CONNECTOR, RECEPTACL .....	1
2	XBFZZ	80063	SC-C-681320	BAND IDENTIFICATION .....	1
3	PAFZZ	96906	MS25036-102	TERMINAL, LUG.....	7
GROUP 0301 CABLE ASSEMBLY					
FIGURE 9					
1	PAFZZ	80063	SM-C-439958-2	CONNECTOR, RECEPTACL .....	1
2	XBFZZ	80063	SC-C-681320	BAND IDENTIFICATION .....	1
3	PAFZZ	96906	MS525036-102	TERMINAL, LUG.....	6
GROUP 0301 CABLE ASSEMBLY					
FIGURE 10					
1	XBFZZ	80063	A3002168	PLATE SUB ASSEMBLY .....	1
2	PAFZZ	80063	SM-C-374851	SOCKET, PLUG-IN ELEC .....	1

## SECTION II

TM 11-6625-2971-24P

(1) ITEM NO	(2) SMR CODE	(3) PART FSCN	(4) NUMBER	(5) DESCRIPTION AND USABLE ON CODES(UOC)	(6) QTY
3	PAFZZ	80063	SM-D-414117	SOCKET, PLUG-IN ELEC .....	1
GROUP 0301 CABLE ASSEMBLY					
FIGURE 11					
1	PAFZZ	80063	SM-0D-414991	CONNECTOR, RECEPTACL, .....	1
2	XBFZZ	80063	SC-C-681320	BAND IDENTIFICATION .....	1
3	PAFZZ	96906	MS25036-102	TERMINAL, LUG,.....	3
GROUP 0302 CABLE RECEIVER - TRANSMITTER					
FIGURE 12					
1	XAFZZ	80063	A3000788	CONNECTOR BOX, ELEC .....	1
2	PAFZZ	96906	MS3420-8A	BUSHING, RUBBER.....	1
3	PAFZZ	81349	MWIOM(M)D17	CONNECTOR, PLUG, ELEC .....	1
4	PAFZZ	81349	M23053/5-108-4	INSULATION SLEEVING.....	1
5	PAFZZ	03743	CG-3150	CONNECTOR, ELECTRICAL .....	1
6	PAFZZ	59730 141		LOCKNUT, ELECTRICAL .....	1
7	PAFZZ	96906	MS35190-239	SCREW, MACHINE .....	4
8	PAFZZ	96906	MS27183-5	WASHER, FLAT .....	4
9	PAFZZ	96906	MS21044-N06	NUT, SELF-LOCKING, HE .....	4
10	XBFZZ	80063	A3000790	CONNECTOR MODIFIED .....	1
11	XBFFF	80063	A3000787	COVER ASSEMBLY .....	1
12	XBFZZ	71279	415-1276-01-1400	HANDLE.....	1
13	XBFZZ	80063	A3000786	COVER .....	1
14	PAFZZ	96906	MS27183-7	WASHER, FLAT .....	2
15	PAFZZ	96906	MS35338-42	WASHER, LOCK .....	2
16	PAFZZ	96906	MS35206-245	SCREW, MACHINE .....	2
17	PAFZZ	96906	MS27183-4	WASHER, FLAT .....	4
18	PAFZZ	96906	MS35338-40	WASHER, LOCK .....	4
19	PAFZZ	96906	MS35206-217	SCREW, MACHINE .....	4
GROUP 0303 CABLE ASSEMBLY HEAT EXCHANGER EXTENDER					
FIGURE 13					
1	PAFZZ	13499	371-1284-260	CONNECTOR,RECEPTACL .....	1
2	PAFZZ	81349	M24308/20-2	SHIELD, ELECTRICAL C.....	2
3	PAFZZ	81349	MS3367-4-9	STRAP, TIEDOWN, ELECT .....	2
4	XBFZZ	80063	SC-C-681320-7	BAND, IDENTIFICATION .....	1
5	PAFZZ	35003	DAMM11WIS	CONNECTOR, RECEPTACL .....	1
6	PAFZZ	80063	SM-C-500320-31	CONTACT, ELECTRICAL .....	1
7	PAFZZ	96906	M535206-215	SCREW, MACHINE .....	4
8	PAFZZ	96906	MS27183-3	WASHER, FLAT .....	4
9	PAFZZ	96906	MS21044-N04	NUT, SELF-LOCKING, HE .....	4
10	PAFZZ	80063	SM-C-414120-1	CONTACT, ELECTRICAL .....	1

## NATIONAL STOCK NUMBER AND PART NUMBER INDEX

## NATIONAL STOCK NUMBER INDEX

STOCK NUMBER	FIG.	ITEM	STOCK NUMBER	FIG.	ITEM
5310-00-045-3299	12	15	6210-00-834-1564	5	10
5310-00-081-8087	12	9	5995-00-889-0686	1	6
5310-00-082-1404	2	4	5305-00-889-2997	13	7
5310-00-088-0551	13	9	5305-00-889-2999	12	19
5935-00-089-8050	10	3	5985-00-892-3200	5	21
5935-00-102-6141	13	1	5935-00-892-8895	7	1
5320-00-117-6828	3	4	5950-00-904-1057	1	17
	4	4	5935-00-926-7523	1	15
5905-00-119-8811	5	14	5935-00-928-7846	1	13
5905-00-131-1255	5	12		5	16
5935-00-133-0394	8	1	5310-00-950-1310	12	17
	11	1	5310-00-951-4679	13	8
5975-00-152-1075	12	6	5305-00-958-5451	12	7
6240-00-155-7836	5	9	5310-00-983-8483	12	8
5120-00-156-0981	1	27	5305-00-984-6193	12	16
5950-00-170-4153	1	18	5935-01-037-4328	13	2
5340-00-178-7870	4	5	5120-01-066-8422	1	28
5120-00-190-5756	1	25	5120-01-068-1843	1	31
5940-00-204-8966	5	23	5995-01-111-9249	1	12
	8	3	5995-01-111-9250	1	11
	9	3	5995-01-111-9251	1	8
	11	3	5995-01-111-9255	1	4
5935-00-225-9929	1	14	5995-01-111-9346	5	18
5935-00-227-8818	6	1	6625-01-115-4383	1	10
5340-00-237-6254	3	3	5330-01-135-2568	1	21
5120-00-241-5521	1	32	5950-01-167-4835	1	19
5999-00-263-1051	1	16	6625-01-183-5503	2	2
5940-00-283-5280	6	2	6625-01-183-5504	3	1
5975-00-350-8141	3	5	5995-01-185-4228	5	28
5930-00-359-5318	5	8	5995-01-185-4229	1	9
5120-00-406-3181	1	26	5995-01-185-4231	1	5
5935-00-435-8657	13	5	8105-01-187-9815	1	1
5995-00-467-3883	1	7			
5310-00-543-2410	12	18			
5365-00-598-5394	12	2			
5930-00-655-1515	5	6			
5930-00-655-1516	5	1			
5930-00-655-1582	5	2			
5120-00-724-3767	1	30			
5975-00-727-5153	5	29			
	13	3			
5935-00-728-4514	5	4			
5999-00-740-0533	13	6			
5310-00-775-5063	4	2			
5310-00-809-8544	12	14			
5935-00-815-2325	12	3			
5935-00-823-0308	5	3			
5935-00-823-0766	10	2			
5995-00-823-2726	1	3			
5995-00-823-2934	5	17			

## NATIONAL STOCK NUMBER AND PART NUMBER INDEX

FSCM	PART NUMBER	PART NUMBER INDEX		FIG.	ITEM
			STOCK NUMBER		
80063	A3000706			5	20
80063	A3000711		5995-01-111-9255	1	4
80063	A3000713		5995-01-111-9251	1	8
80063	A3000715			1	22
80063	A3000716			1	23
80063	A3000717			1	29
80063	A3000718			5	11
80063	A3000719			1	24
80063	A3000721			4	3
80063	A300078		55995-01-111-9249	1	12
80063	A3000786			12	13
80063	A3000787			12	11
80063	A3000788			12	1
80063	A3000790			12	10
80063	A3000791		5995-01-185-4231	1	5
80063	A3000793		5995-01-111-9250	1	11
80063	A3000796		6625-01-115-4383	1	10
80063	A3000800		59911-9346	5	18
80063	A3002167			5	7
80063	A3002168			10	1
80063	A3002169			3	2
80063	A3002170		6625-01-183-5503	2	2
80063	A3002170-1			4	1
80063	A3002171			2	1
80063	A3002171-1		6625-01-183-5504	3	1
80063	A3002173			5	27
80063	A3002174			2	3
80063	A3002176		5995-01-185-4229	1	9
80063	A3002177			5	26
80063	A3002178			5	24
80063	A3002179		5995-01-185-4228	5	
80063	A3002180			5	25
80063	A3002186		8105-01-187-9815	1	1
80063	A3002187			1	2
80063	A3002188			5	22
80063	A3002195-1			1	20
80063	A3002798			5	15
03743	CG-3150			12	5
80058	CGI127BU2-6		5995-00-467-3883	1	
80058	CX-4720/VRC(IOFT		5995-00-823-2726	1	3
35003	DAMMIWIWS		5935-00-435-8657	13	5
99256	LK632-2		5310-00-775-5063	4	2
96906	MS18015-2		5340-00-178-7870	4	5
96906	MS18015-3		5340-00-237-6254	3	3
96906	MS20470-AD4-6		5320-00-117-6828	3	4
				4	4
96906	MS21044-N04		5310-00-088-0551	13	9
96906	MS21044-N06		5310-00-081-8087	12	9
96906	MS24523-21			5	5
96906	MS25036-102		5940-00-204-8966	5	23
				8	3

## NATIONAL STOCK NUMBER AND PART NUMBER INDEX

FSCM	PART NUMBER	PART NUMBER INDEX		FIG.	ITEM
			STOCK NUMBER		
96906	MS25036-102		5940-00-204-8966	9	3
				11	3
96906	MS25036-106		5940-00-283-5280	6	2
96906	MS25237-327		6240-00-155-7836	5	9
96906	MS27183-13			5	19
96906	MS27183-3		5310-00-951-4679	13	8
96906	MS27183-4		5310-00-950-1310	12	17
96906	MS27183-5		5310-00-983-8483	12	8
96906	MS27183-6		5310-00-082-1404	2	4
96906	MS27183-7		5310-00-809-8544	12	14
96906	MS3367-4-9		5975-00-727-5153	5	29
				13	3
96906	MS3420-8A		5365-00-598-5394	12	2
96906	MS35058-23		5930-00-655-1515	5	6
96906	MS35058-24		5930-00-655-1516	5	1
96906	MS35059-23		5930-00-655-1582	5	2
96906	MS35190-239		5305-00-958-5451	12	7
96906	MS35206-215		5305-00-889-2997	13	7
96906	MS35206-217		5305-00-889-2999	12	19
96906	MS35206-230			2	5
96906	MS35206-245		5305-00-984-6193	12	16
96906	MS35338-40		5310-00-543-2410	12	18
96906	MS35338-42		5310-00-045-3299	12	15
81349	MWL0M(M)DL7		5935-00-815-2325	12	3
81349	MW20(MM)A00		5935-00-227-8818	6	1
81349	M23053/5-108-4			12	4
81349	M24308/20-2		5935-01-037-4328	13	2
81349	M39024/10-01		5935-00-728-4514	5	4
81349	M55339/13-00492		5935-00-823-0308	5	3
81349	M55339/17-00274		5935-00-926-7523	1	15
81349	M8805/96-001		5930-00-359-5318	5	8
81349	RCR07G122JS		5905-00-131-1255	5	12
81349	RCR07G151JS		5905-00-119-8811	5	14
80063	SC-C-681320			7	2
				8	2
				9	2
				11	2
80063	SC-C-681320-7			13	4
80063	SC-D-68284- 4- 1		5995-00-889-0686	1	6
80063	SM-B-481760		5330-01-135-2568	1	21
80063	SM-C-374851		5935-00-823-0766	10	2
80063	SM-C-413781		5950-01-167-4835	1	19
80063	SM-C-414120-1			13	10
80063	SM-C-439958-2			9	1
80063	SM-C-500320-31		5999-00-740-0533	13	6
80063	SM-D-414117		5935-00-089-8050	10	3
80063	SM-D-414364-8		5995-00-823-2934	5	17
80063	SM-0-414384		5985-00-892-3200	5	21
80063	SM-D-414991		5935-00-133-0394	8	1
				11	1
59730	TC105		5975-00-350-8141	3	5

## NATIONAL STOCK NUMBER AND PART NUMBER INDEX

FSCM	PART NUMBER	PART NUMBER INDEX		FIG.	ITEM
		STOCK NUMBER			
81349	U-288/U	5935-00-892-8895		7	1
81348	WC440TYPETC1	5999-00-263-1051		1	16
05574	000407-0003	5120-01-066-8422		1	28
05574	000407-0004	5120-01-068-1843		1	31
59730	141	5975-00-152-1075		12	6
83330	1496			5	13
72619	177-8430-0933-50	6210-00-834-1564		5	10
	3				
71279	3226-3	5950-00-904-1057		1	17
13499	371-1284-260	5935-00-102-6141		13	1
71279	415-1276-01-1400			12	12
98291	51-074-6800	5935-00-928-7846		1	13
				5	16
98291	51-085-0000	5935-00-225-9929		1	14
71279	515-3226-04-21-0	5950-00-170-4153		1	18
	0				
73899	5284	5120-00-724-3767		1	30
96508	99-23	5120-00-190-5756		1	25
96508	99-25	5120-00-406-3181		1	26
96508	99-4	5120-00-241-5521		1	32
96508	99-964	5120-00-156-0981		1	27

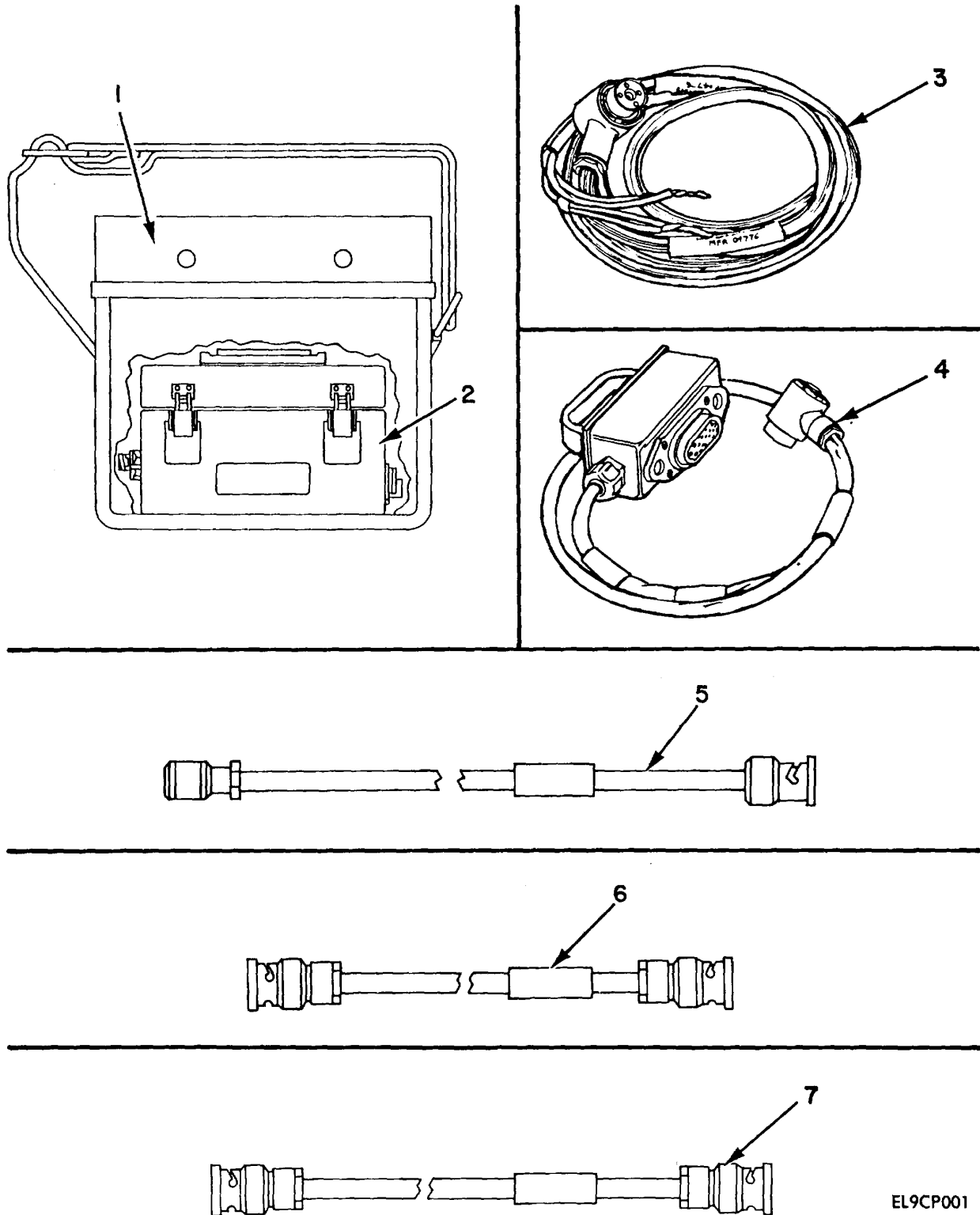

EL9CP001

Figure 1. Maintenance Kits, Electronic Equipment MK-1978A/VRC (Sheet 1 of 4.)

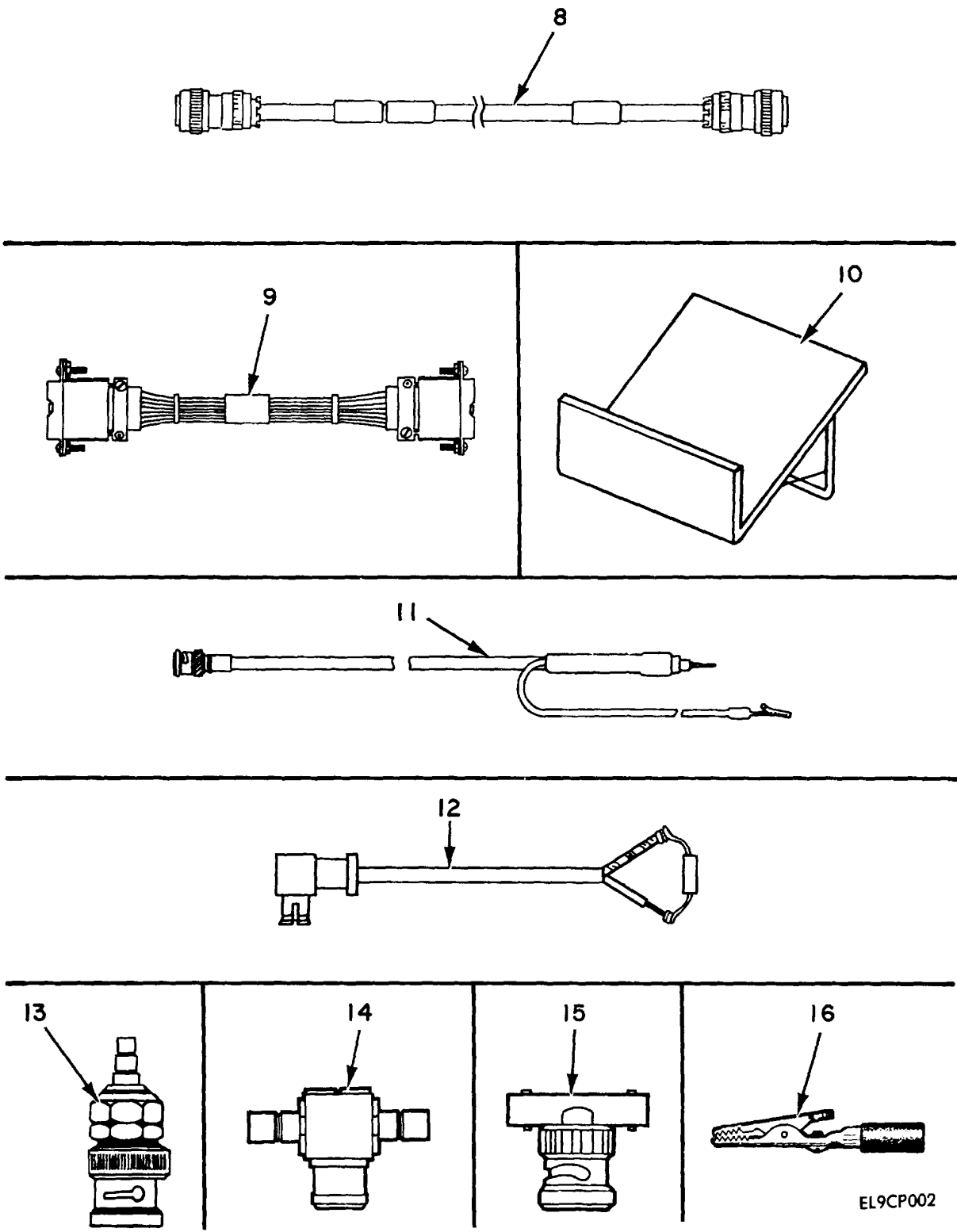

EL9CP002

Figure 1. Maintenance Kits, Electronic Equipment MK-1978A/VRC (Sheet 2 of 4).



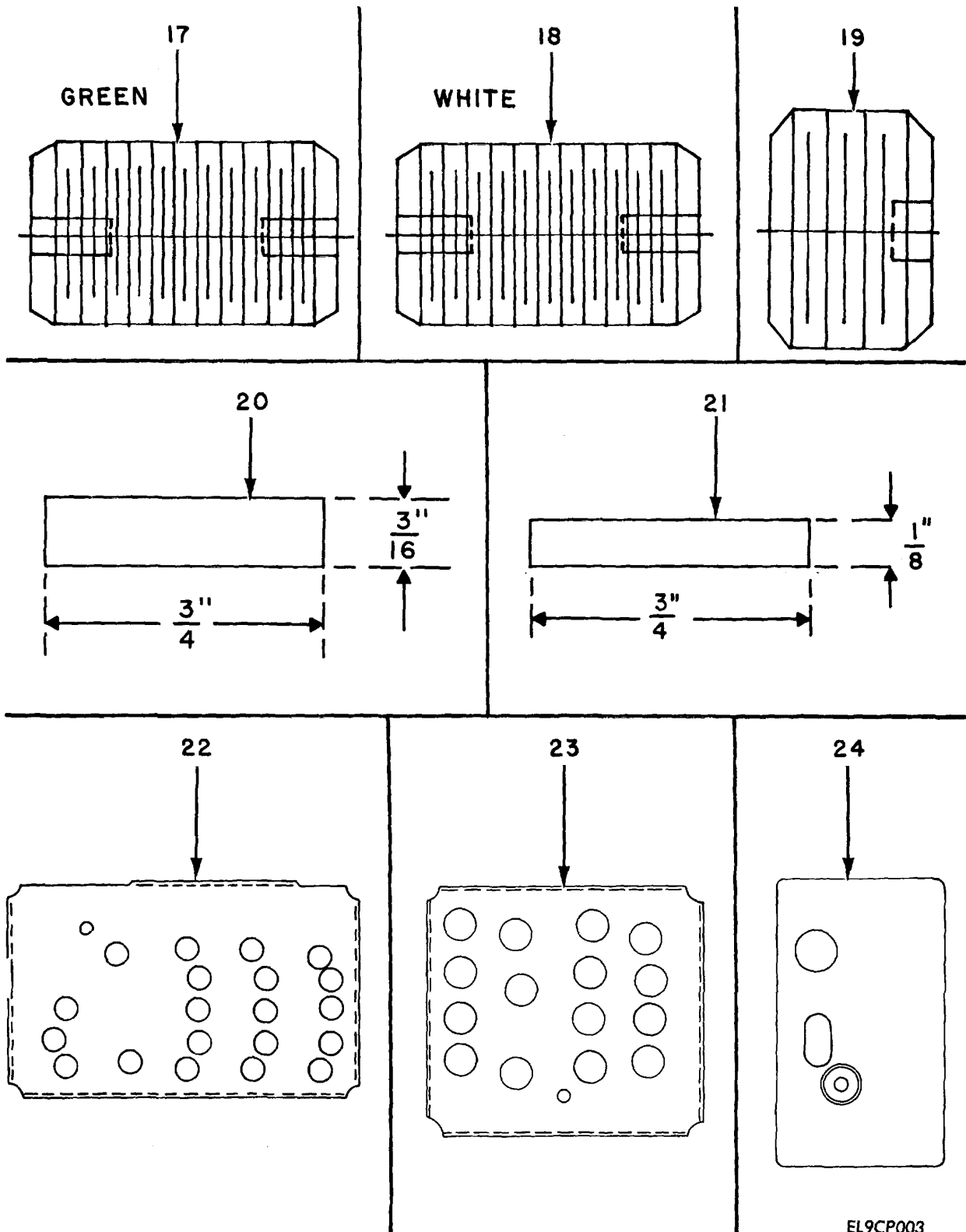

EL9CP003

Figure 1. Maintenance Kits, Electronic Equipment MK-1978A/VRC (Sheet 3 of 4).

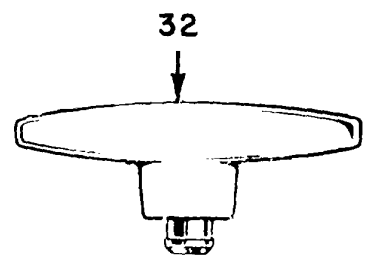
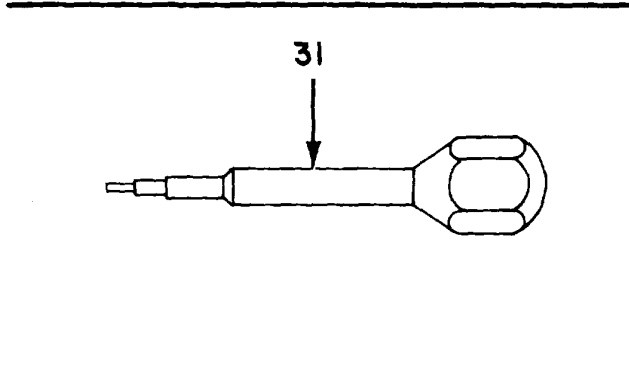
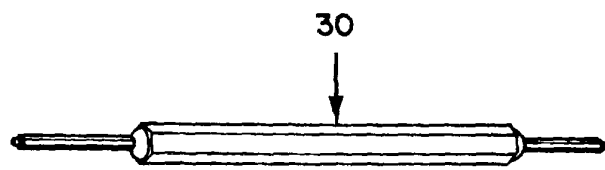
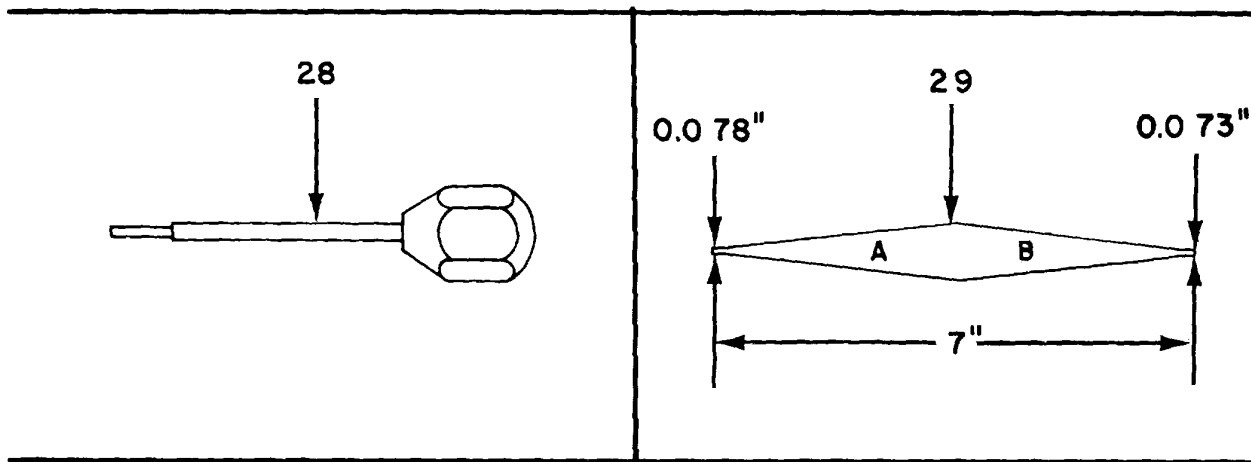
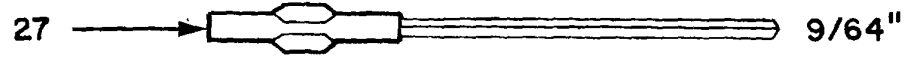
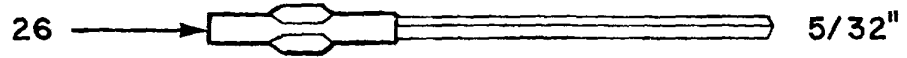
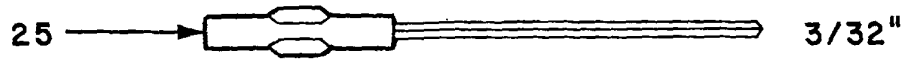

EL9CP004

Figure 1. Maintenance Kits, Electronic Equipment MK-1978A/VRC (Sheet 4 of 4).

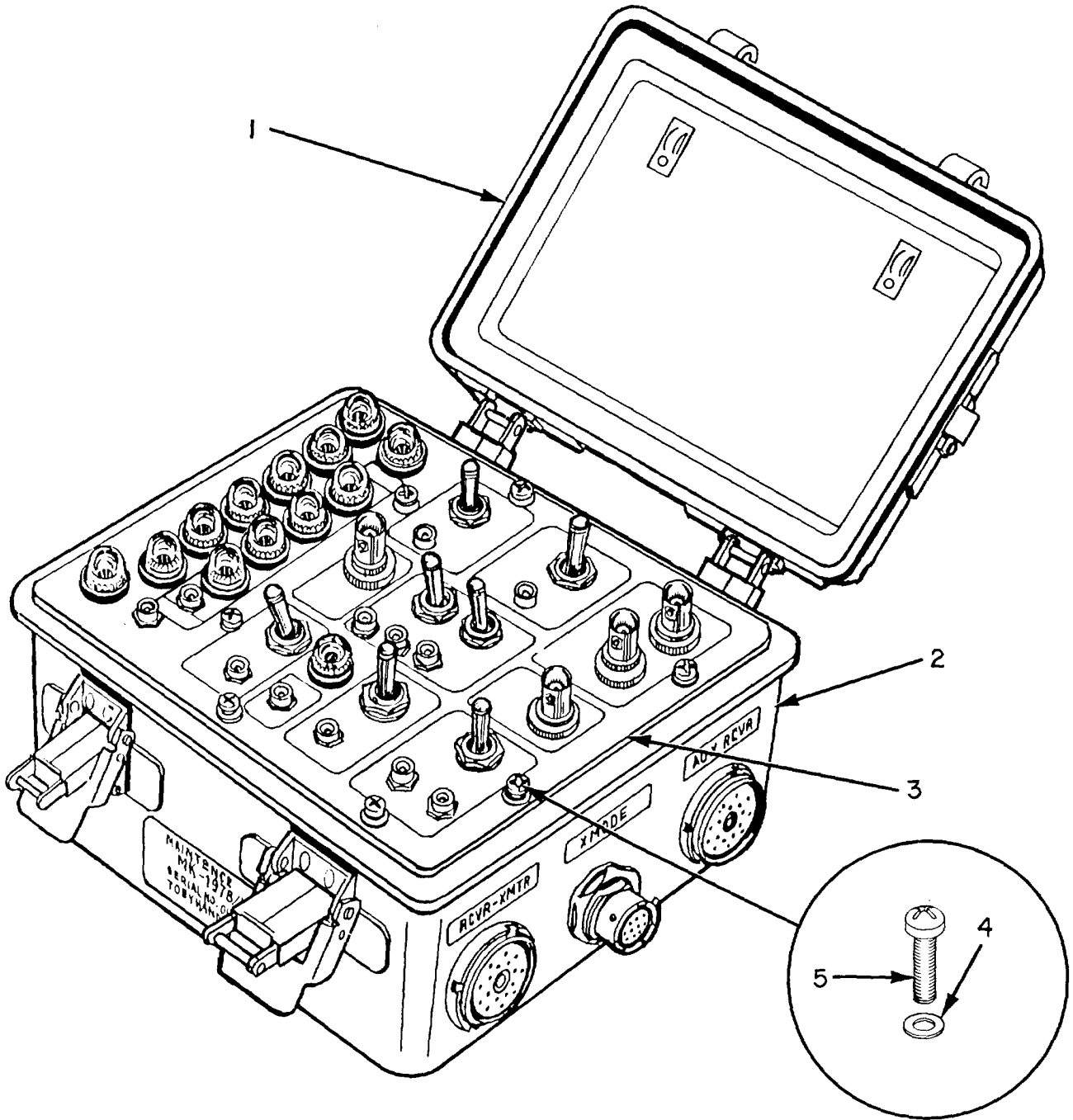

Figure 2. Maintenance Kit Assembly.

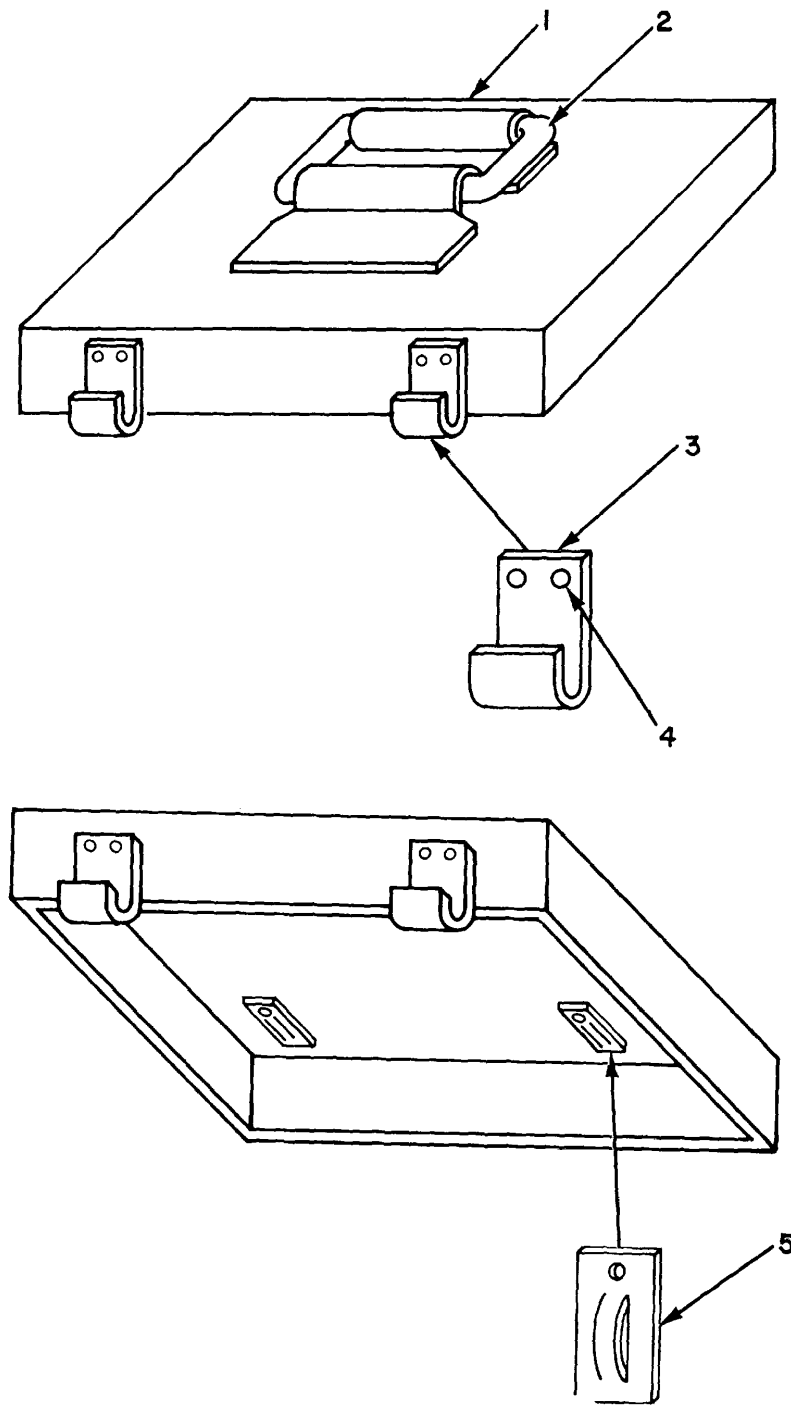
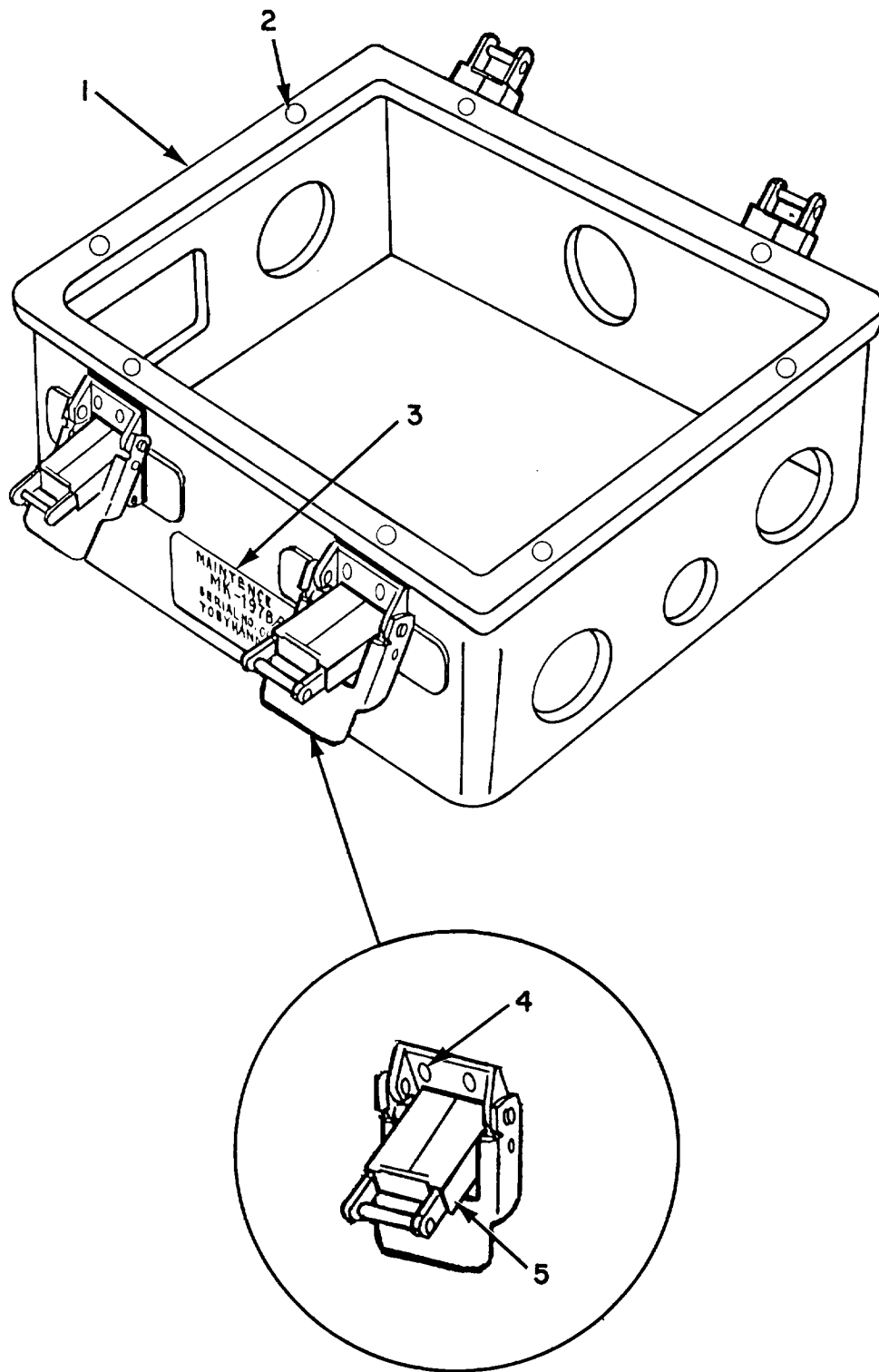

Figure 3. Cover Assembly.

EL9CP006



EL9CP007

Figure 4. Case Assembly.

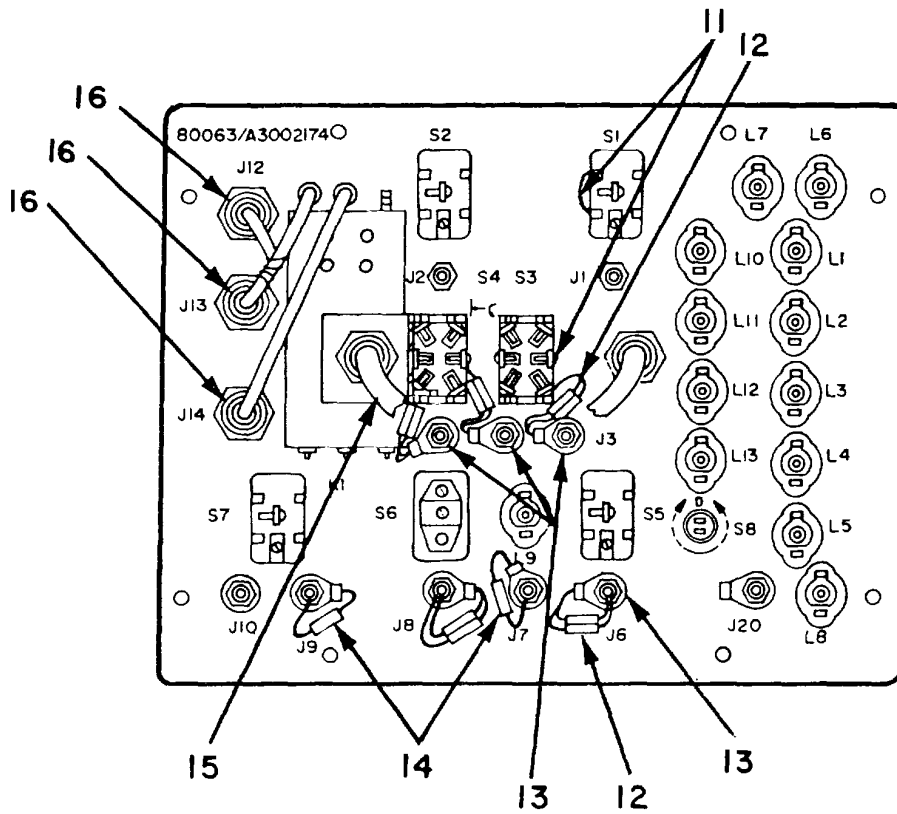
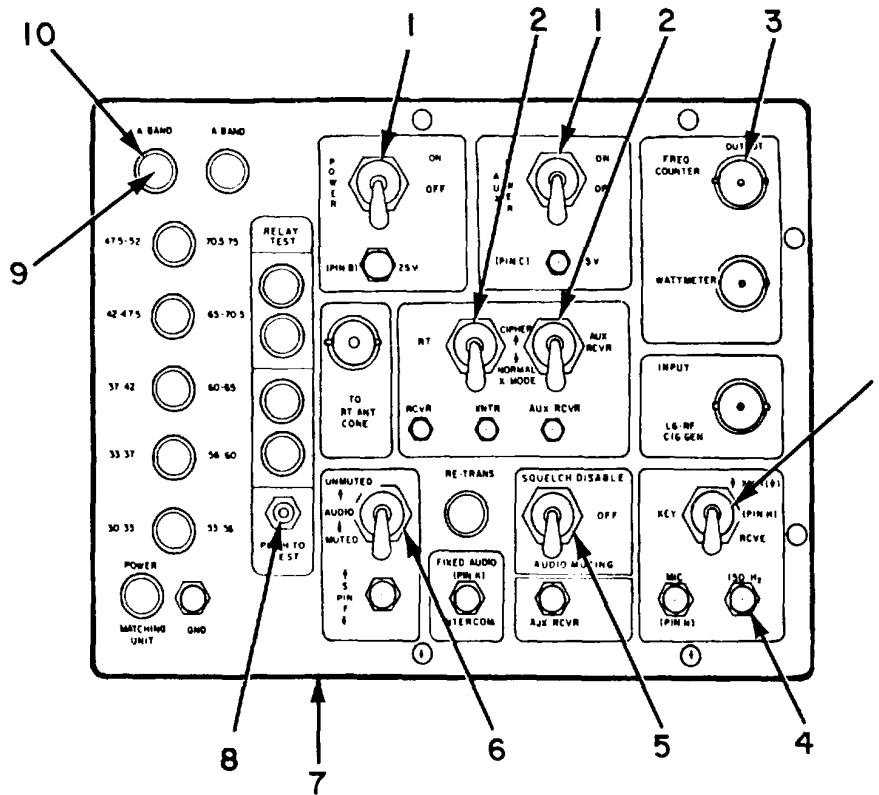

EL9CP008

Figure 5. Panel Assembly (Sheet 1 of 4).

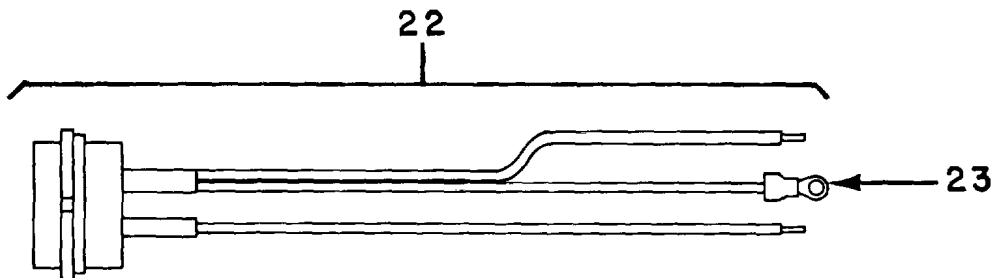
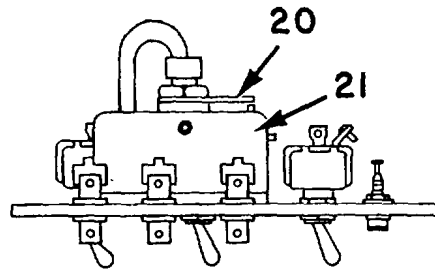
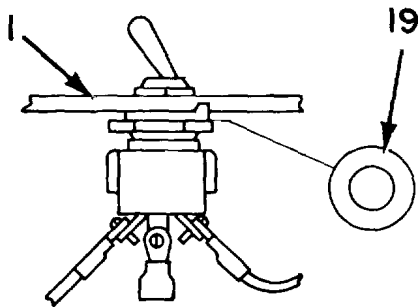
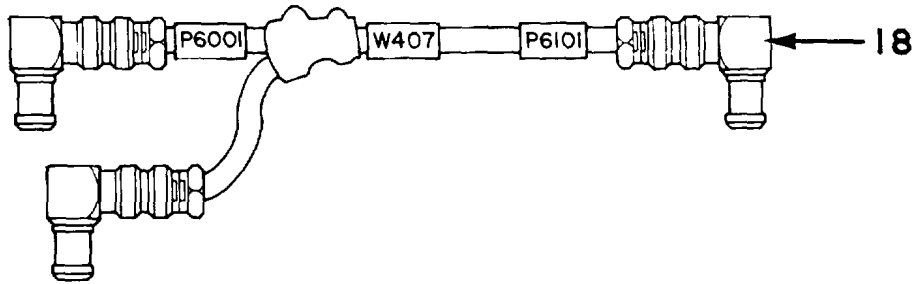
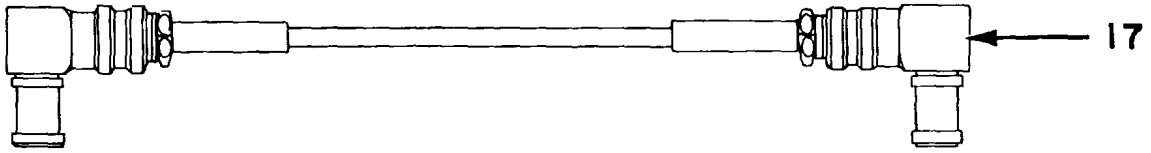

Figure 5. Panel Assembly (Sheet 2 of 4).

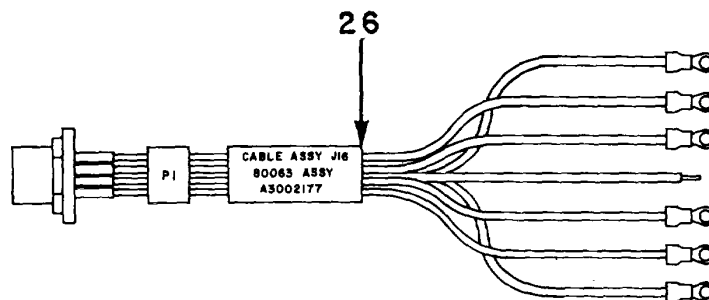
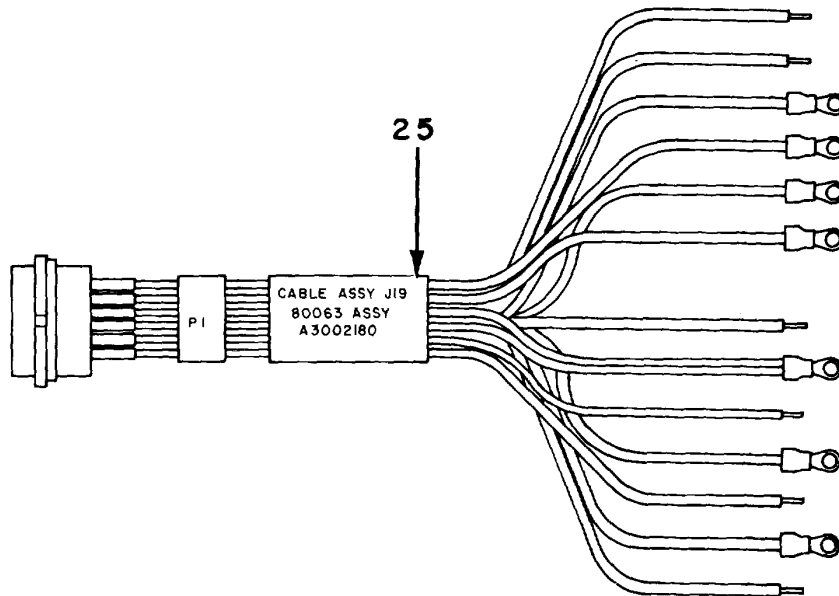
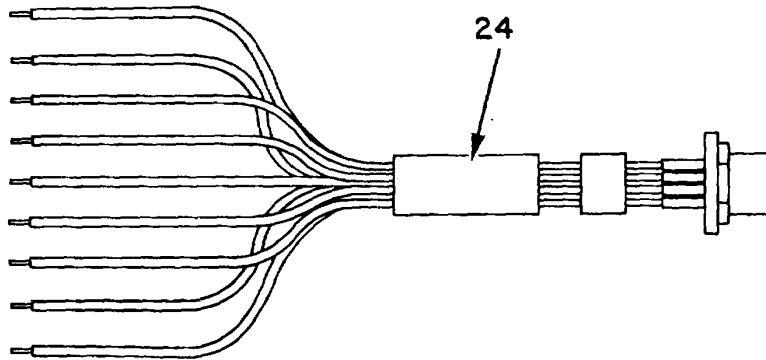
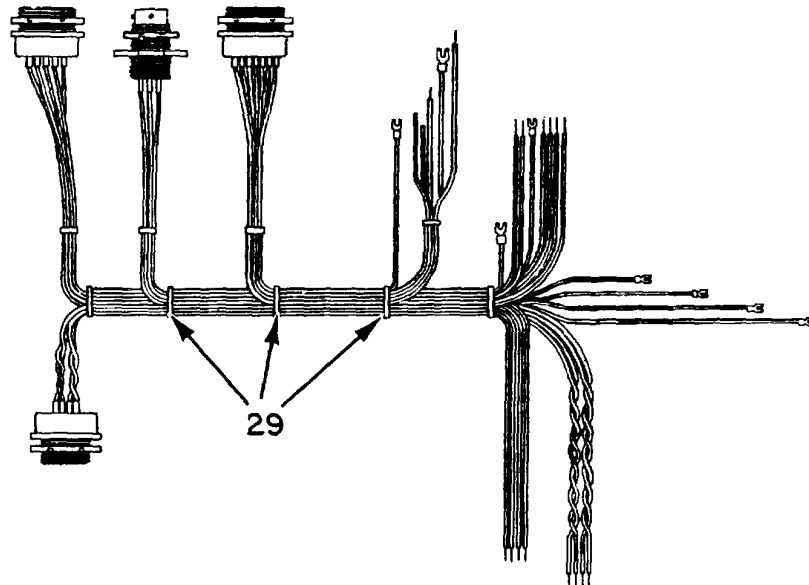
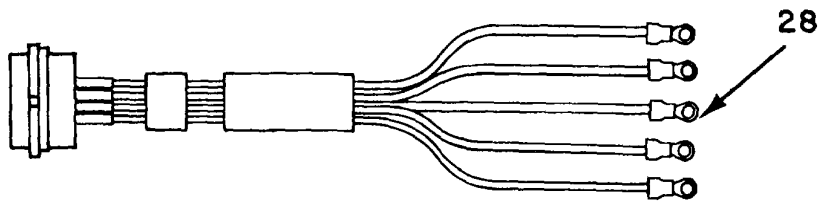
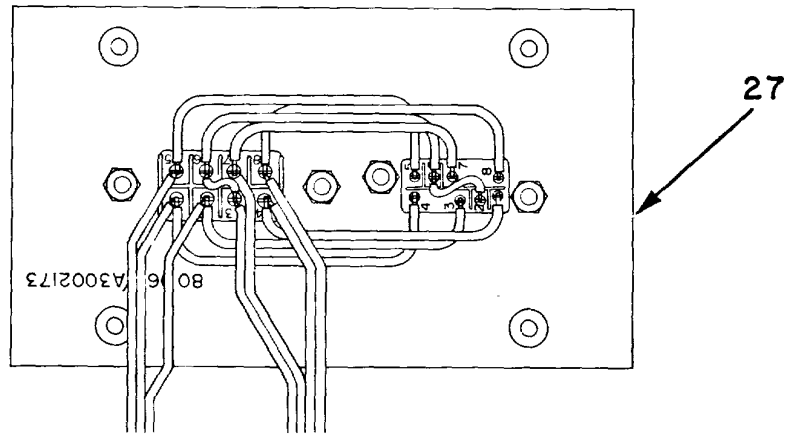

Figure 5. Panel Assembly (Sheet 3 of 4).





EL9CP011

Figure 5. Panel Assembly (Sheet 4 of 4).

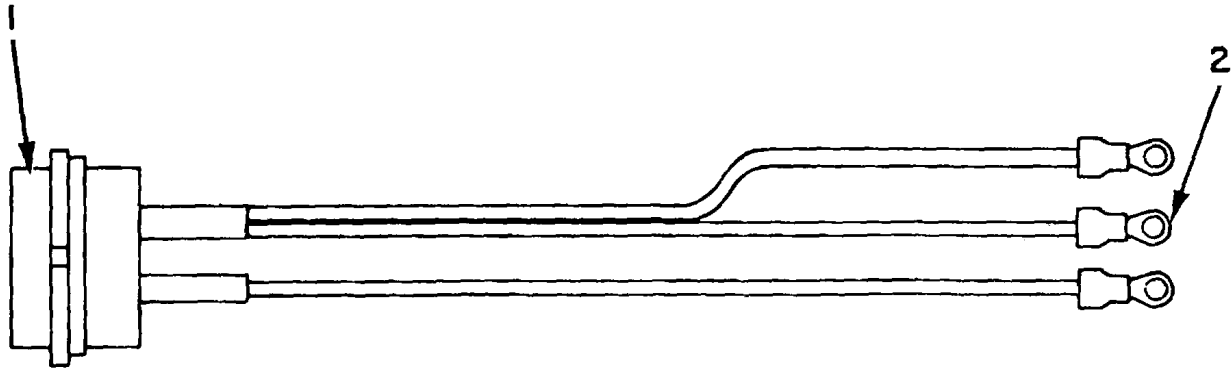

EL9CP012

Figure 6. Cable Assembly.

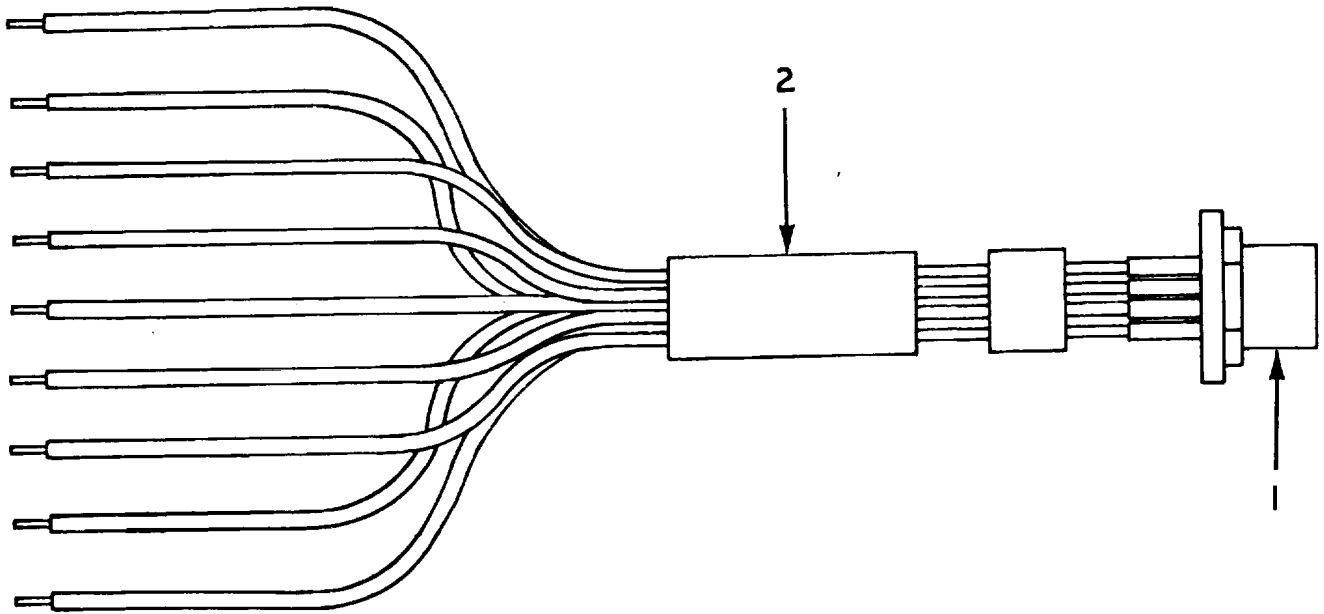

EL9CP013

Figure 7. Cable Assembly.

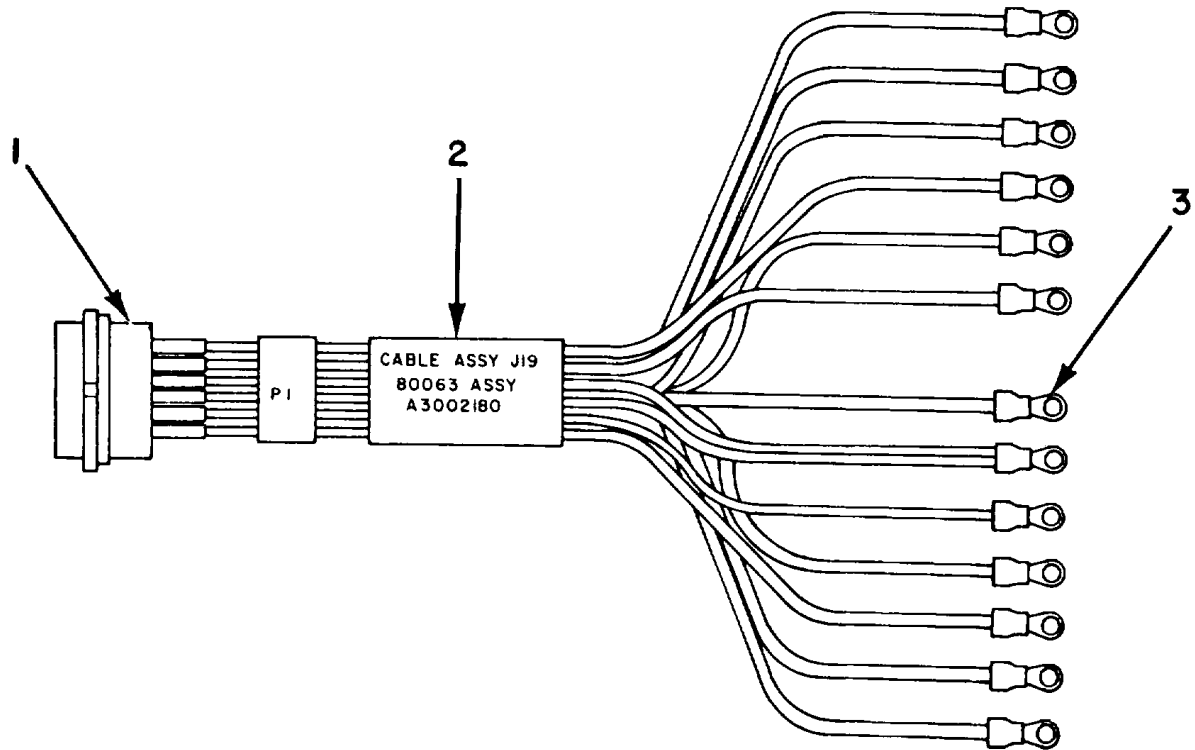

EL9CF014

Figure 8. Cable Assembly.

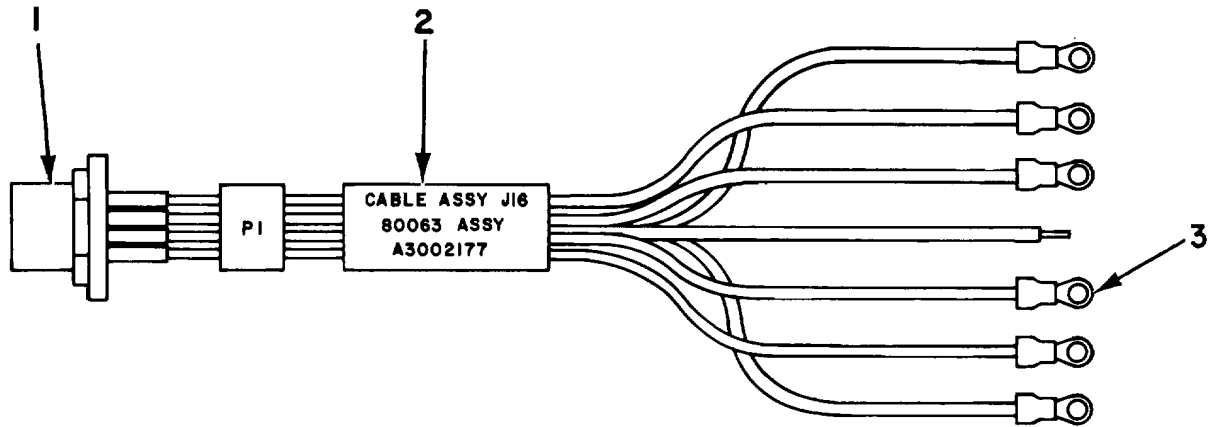

EL9CP015

Figure 9. Cable Assembly.

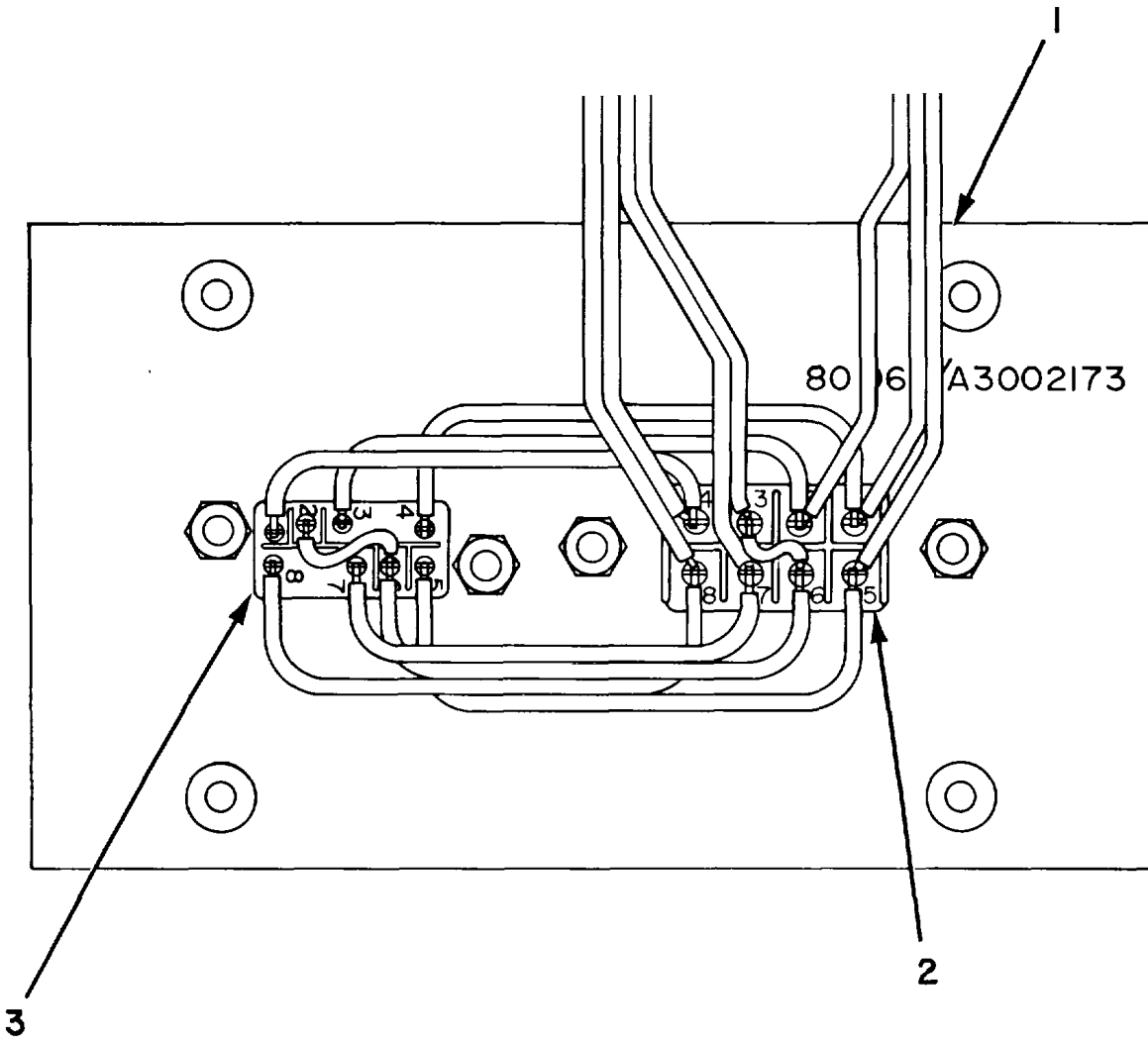
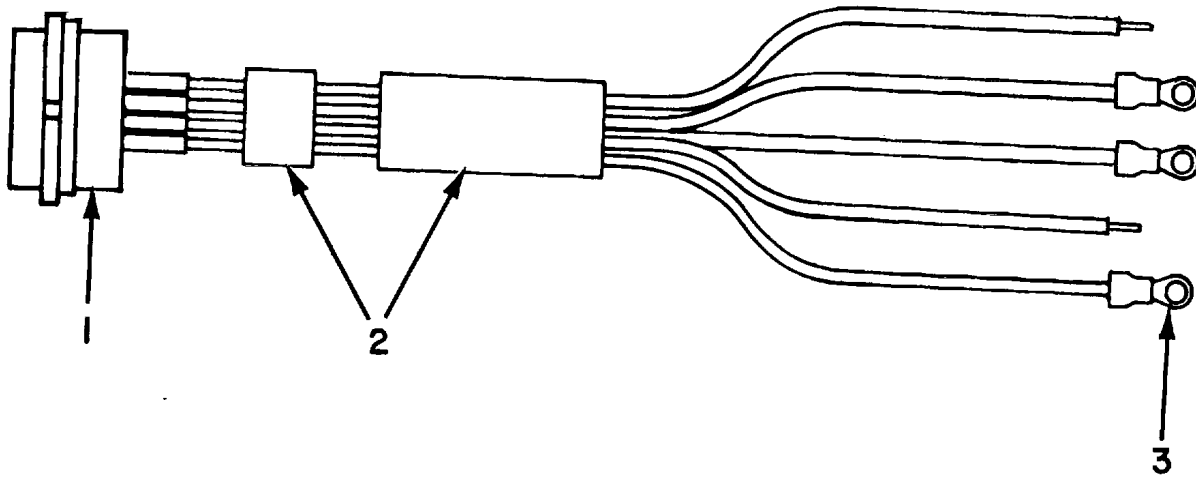
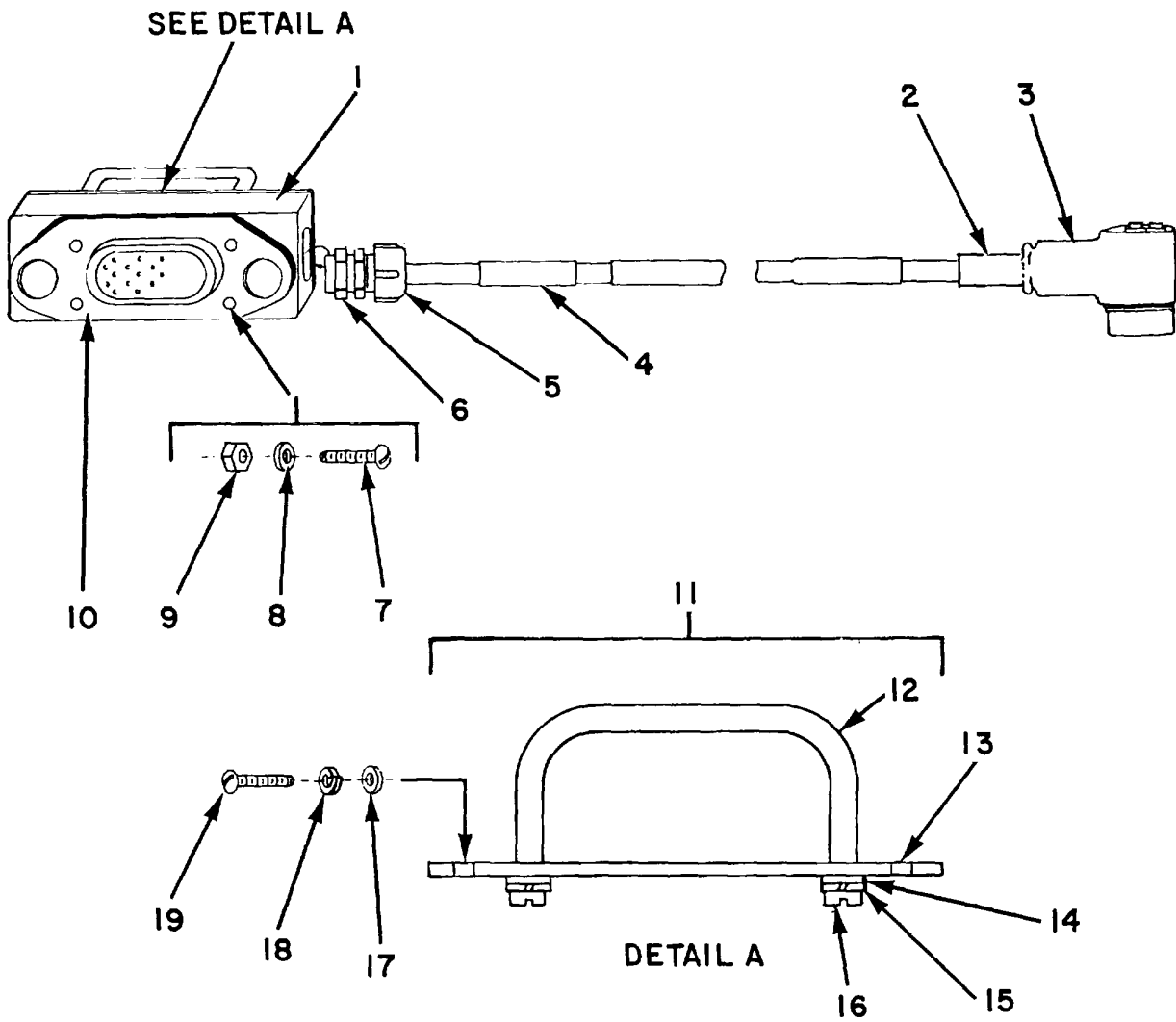

Figure 10. Cable Assembly.



EL9CP017

Figure 11. Cable Assembly.



EL9CP018

Figure 12. Cable, Receiver-Transmitter.



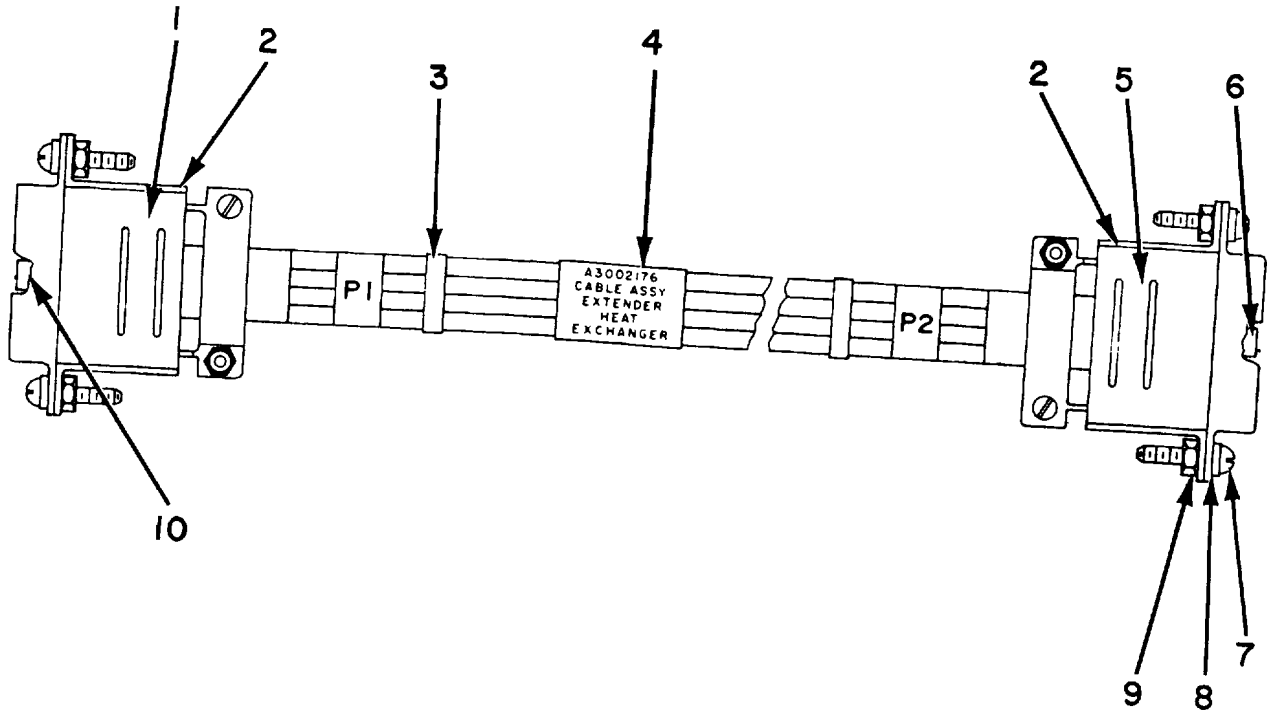

EL9CP019

Figure 13. Cable Assembly, Heat Exchanger Extender.

By Order of the Secretary of the Army:

Official:

JOHN A.. WICKHAM JR.  
*General, United States Army*  
*Chief of Staff*

DONALD J. DELANDRO  
*Brigadier General, United States Army*  
*The Adjutant General*

DISTRIBUTION:

To be distributed in accordance with DA Form 12-51 requirements for AN/VRC-12.

\*U.S. GOVERNMENT PRINTING OFFICE: 1985-505-044/20063



